

Bench Mark: PK Nail in pavement on the north side of structure. Station 781+40.56, Offset 16.74 Left, Elevation 790.59.

Existing Structure: S.N. 071-0001 originally built in 1937 as SBI 70 Section 106 VC and VB and rehabilitated in 1978 as SBI 70 Section 106-V-BR. Structure consists of 5 span W shape steel girders non-continuous at Pier 3 and reinforced concrete deck supported by open counterfort abutments on timber piles and multi-column piers on timber piles. Structure measures 236'-6 1/2" back to back of abutments and 43'-2" out-to-out. The existing bridge deck is to be removed and replaced and the substructure to be repaired. Traffic to be detoured during construction.

No salvage.

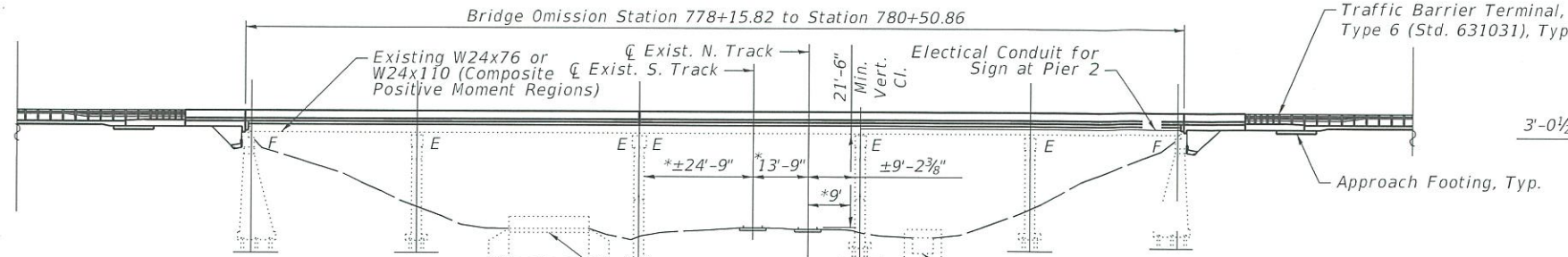

Note:
Railroad Clearance information from Record Drawings and IDOT Reports.
No freefall deck drains will be permitted in the span over the tracks or within 10 ft. of cross arms of a railroad pole line.

ELEVATION

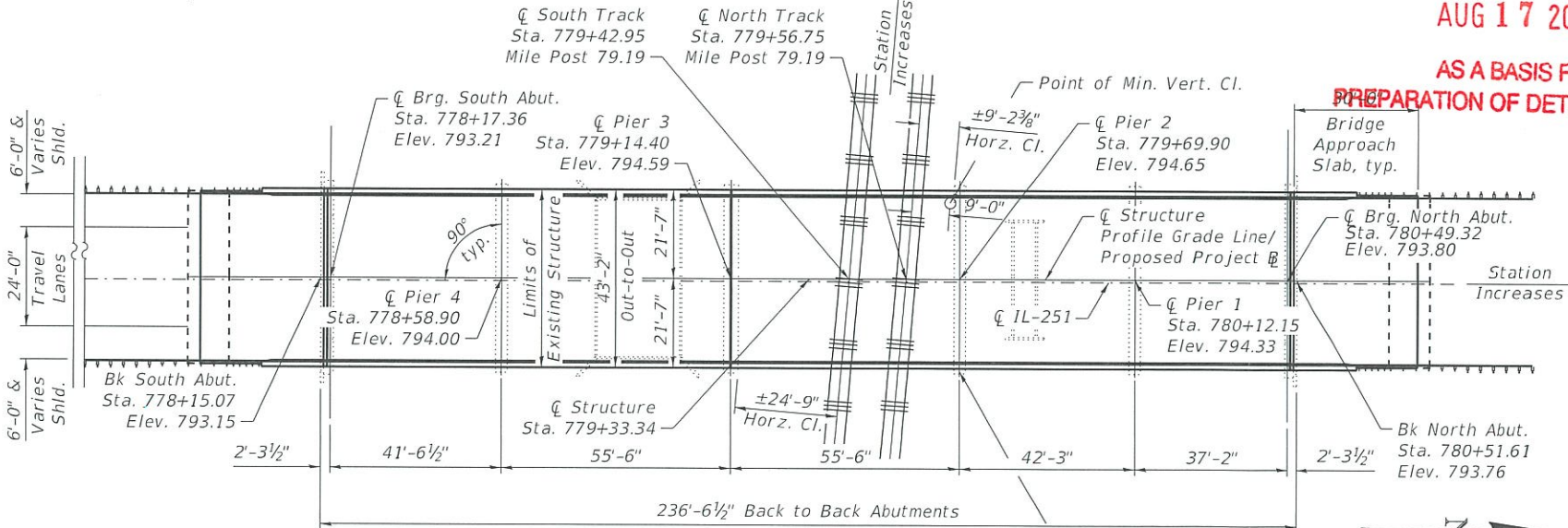

PLAN

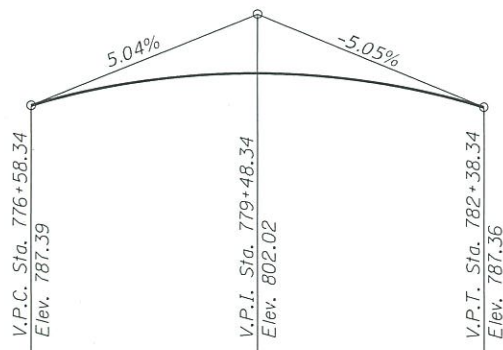

PROFILE GRADE
(Along PGL)

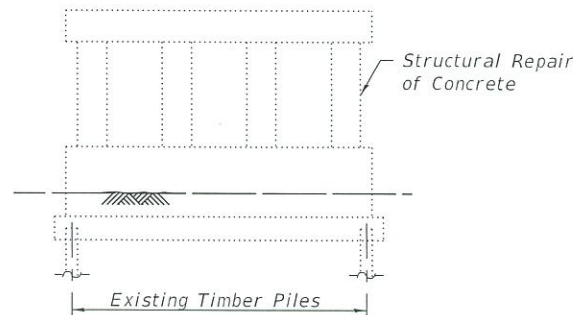

PIER SKETCH

APPROVED
AUG 17 2018
AS A BASIS FOR
PREPARATION OF DETAILED PLANS

SEISMIC DATA

Seismic Performance Category (SPC) = A
Horizontal Bedrock Acceleration Coefficient (A) = 0.034g
Site Coefficient (S) = 1.2

**DESIGN SPECIFICATIONS
(NEW CONSTRUCTION)**

2002 AASHTO Standard Specifications
for Highway Bridges

LOADING HS20-44 (NEW CONSTRUCTION)
Allow 25#/sq. ft. for future wearing surface.

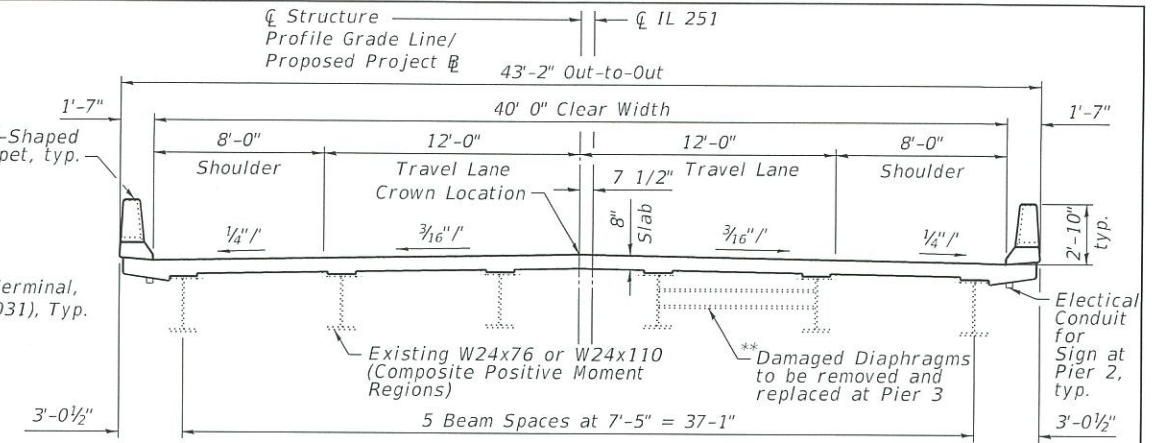

CROSS SECTION
(LOOKING NORTH)

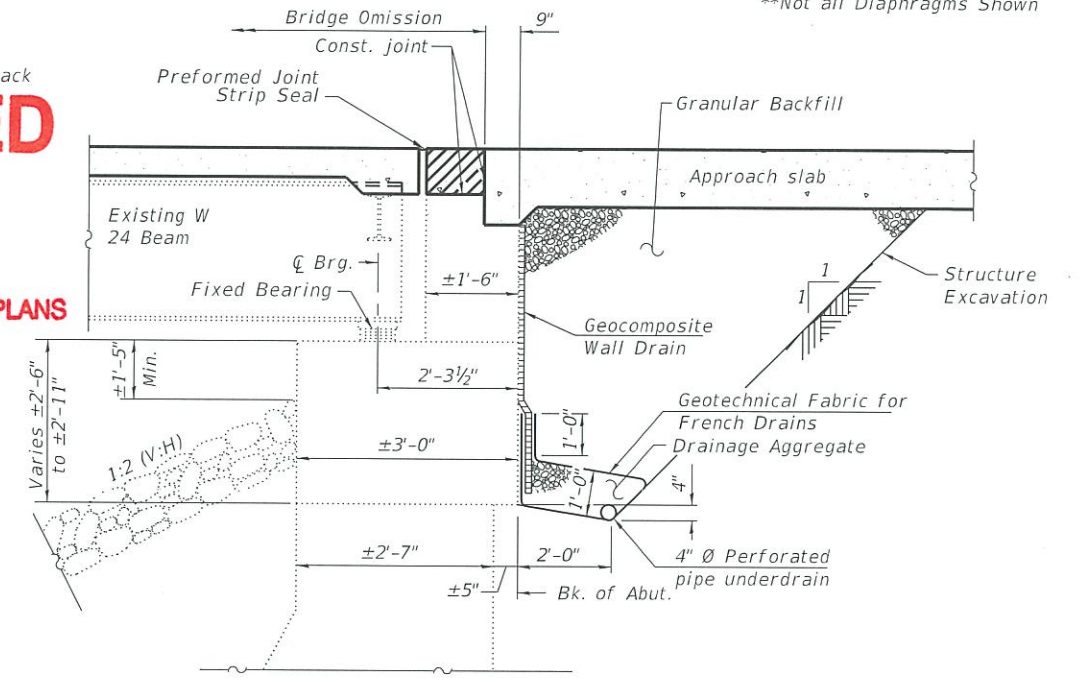

SECTION THRU ABUTMENT

DESIGN STRESSES

FIELD UNITS (NEW CONSTRUCTION)

f'c = 3,500 psi
f'c = 4,000 psi (Superstructure Concrete)
fy = 60,000 psi (Reinforcement)
fy = 50,000 psi (M270 Grade 50)

FIELD UNITS (EXISTING CONSTRUCTION)

f'c = 3,500 psi
fy = 60,000 psi (Reinforcement 1978)
fy = 33,000 psi (Reinforcement 1937)
fy = 50,000 psi (M222 Grade 50)

HIGHWAY CLASSIFICATION

FAS Rte. 1042 - IL 251
Functional Class: Minor Arterial (Non-Urban)
ADT: 3,850 (2018); 4,750 (2038)
ADTT: 256 (2018); 319 (2038)
DHV: 475
Design Speed: 45 m.p.h.
Posted Speed: 45 m.p.h.
2-Way Traffic
Directional Distribution: 50:50

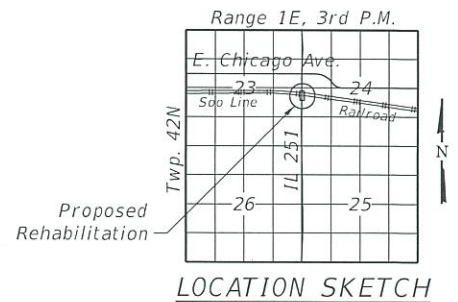

LOCATION SKETCH

**GENERAL PLAN AND ELEVATION
IL-251 OVER S00 LINE RAILROAD
F.A.S. RT. 1042 - SEC. 106-V-BR
OGLE COUNTY
STATION 779+33.34
STRUCTURE NO. 071-0001**

MODEL: Default
FILE NAME: P:\02221\004-WBK-IDOT Dist 2, P1B, 1B1 Item 9, Various Phase 11\Work-Order 3\Design\CADD\CADD_Sheets\WORKING 0710001-64L75-001-TEL.dgn



USER NAME = rdoerr
PLOT SCALE =
PLOT DATE = 7/24/2018

DESIGNED - RRD	REVISED -
CHECKED - SMO	REVISED -
DRAWN - RRD	REVISED -
CHECKED - SMO	REVISED -

STATE OF ILLINOIS
DEPARTMENT OF TRANSPORTATION

GENERAL PLAN
STRUCTURE NUMBER 071-0001
SHEET NO. 1 OF 2 SHEETS

F.A.S. RTE.	SECTION	COUNTY	TOTAL SHEETS	SHEET NO.
1042	106-V-BR	OGLE	2	1
			CONTRACT NO. 64L75	
ILLINOIS FED. AID PROJECT				

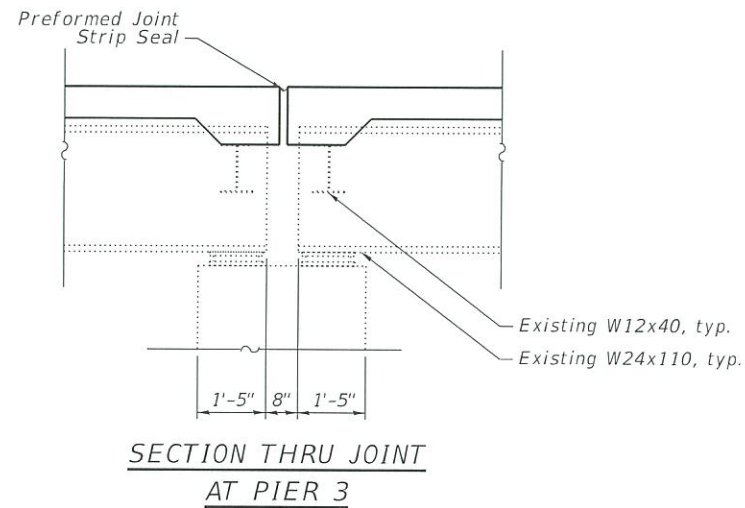

APPROVED

AUG 17 2018

AS A BASIS FOR
PREPARATION OF DETAILED PLANS

MODEL: Default
FILE NAME: P:\02-221-004-WBK-IDOT Dist 2, PTB 1B1 Item 9, Various Phase 11\Work Order 3\Design\CADD\CADD_Sheets\WORKING 0710001-64L75-001-1SL.dgn



USER NAME = rdoerrr	DESIGNED - RRD	REVISED -
PLOT SCALE =	CHECKED - SMO	REVISED -
PLOT DATE = 7/24/2018	DRAWN - RRD	REVISED -
	CHECKED - SMO	REVISED -

STATE OF ILLINOIS
DEPARTMENT OF TRANSPORTATION

GENERAL DETAILS
STRUCTURE NUMBER 071-0001

SHEET NO. 2 OF 2 SHEETS

F.A.S. RTE.	SECTION	COUNTY	TOTAL SHEETS	SHEET NO.
1042	106-V-BR	OGLE	2	2
CONTRACT NO. 64L75				
ILLINOIS FED. AID PROJECT				