

Bench Mark: WES #5. Chiseled "x" on S.W. wingwall of S.N. 081-0004. Elev. 592.85

Existing Structures: S.N. 081-0003 S.B. and 081-0004 N.B. Built in 1961 as F.A.I. Rte. 74. Section 81-2HB-2, at Sta. 194+17.07. Existing dual structures each consist of 4-span reinf. concrete deck on steel WF beams supported by spill-thru pile bent abuts. and multi-column piers. 248'-7" Bk. to Bk. abutments. 53'-6" max., and varies, out-to-out deck. Structures to be removed and replaced. Traffic to be maintained utilizing cross overs. No salvage

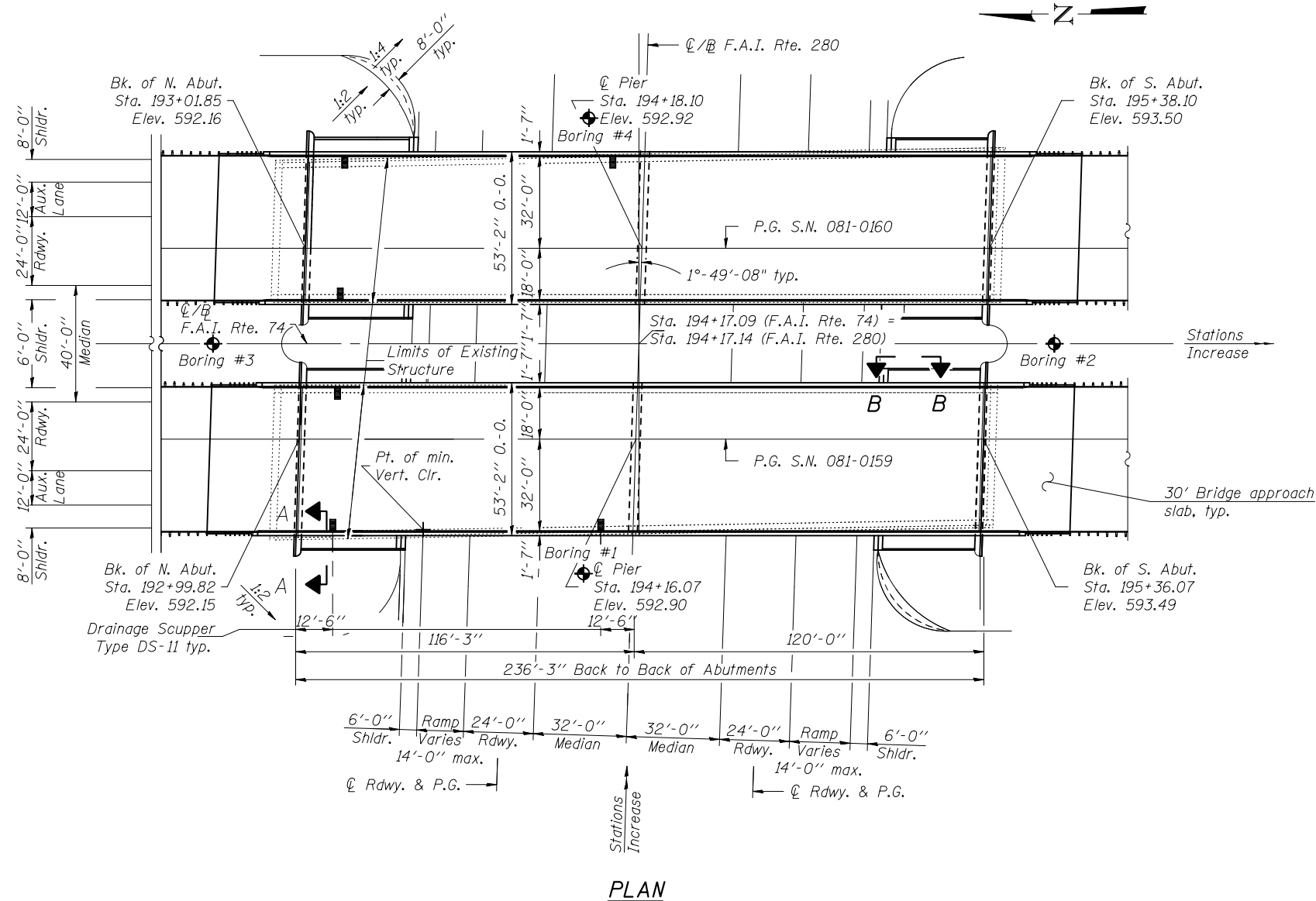
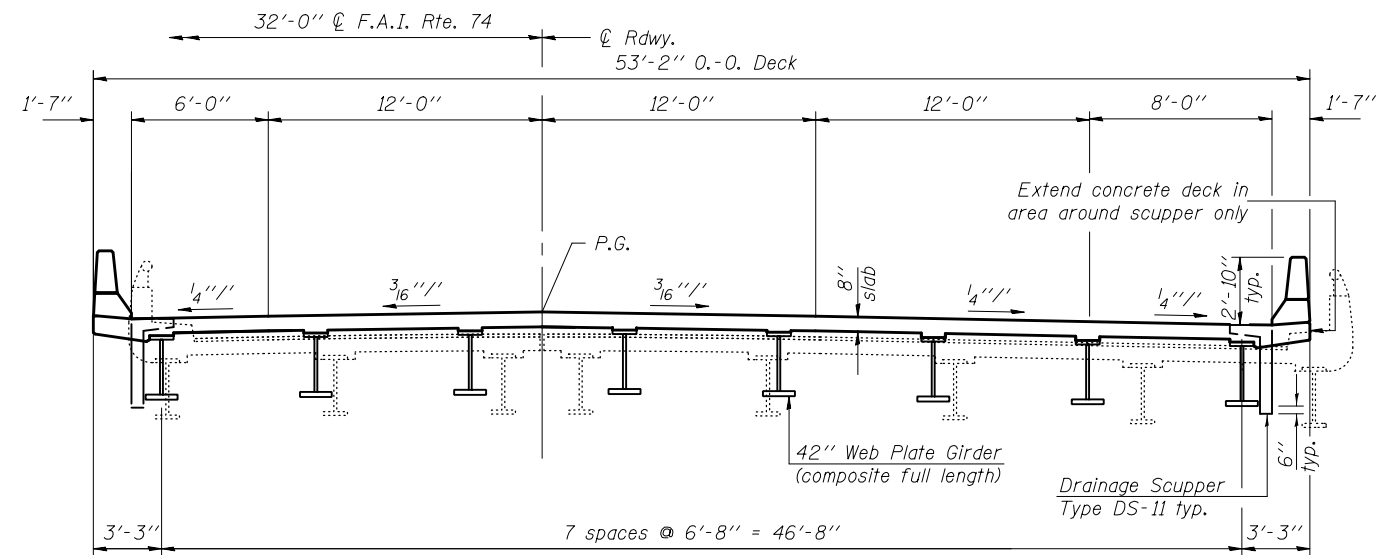
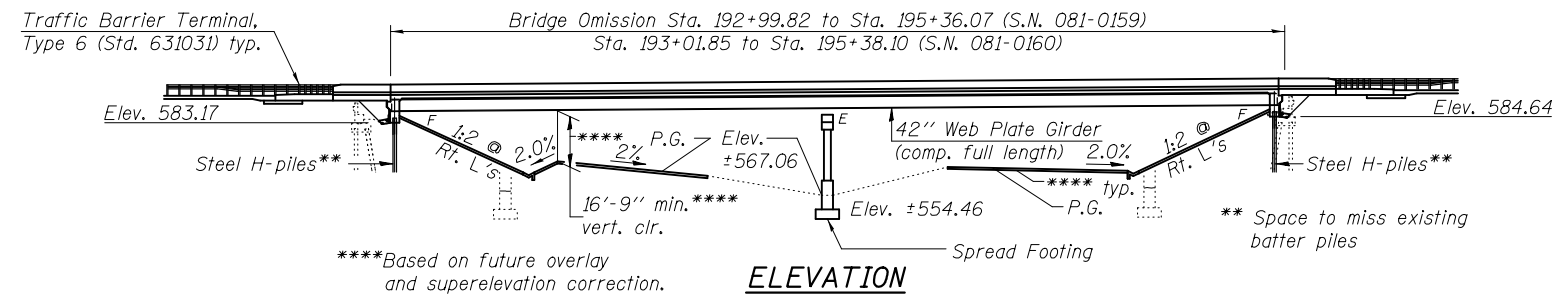

HIGHWAY CLASSIFICATION

F.A.I. Rte. 74 - I-74
Functional Class: Interstate
ADT: 13,050 (2000); 19,400 (2020)
DHV: 1,940 (2020)
Design Speed: 65 mph
Posted Speed: 65 mph

F.A.I. Rte. 280 - I-280
Functional Class: Interstate
ADT: 25,000 (1998); 37,100 (2013)
DHV: 3,710 (2013)
Design Speed: 65 mph
Posted Speed: 65 mph

LOADING HL 93

Allow 50#/sq. ft. for future wearing surface.

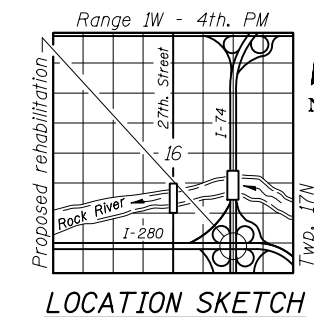
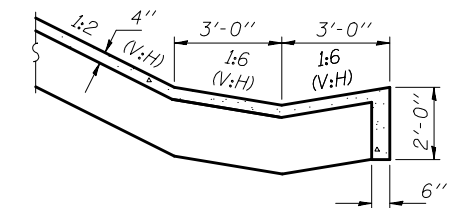
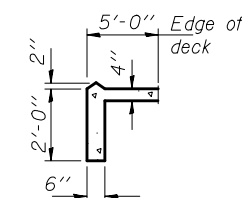

DESIGN SPECIFICATIONS

2010 AASHTO LRFD Bridge Design Specifications

DESIGN STRESSES

FIELD UNITS
f_c = 3,500 psi
f_y = 60,000 psi (reinforcement)
f_y = 50,000 psi (AASHTO M270 Grade 50)

SEISMIC DATA

Seismic Performance Zone (SPZ) = 1
Design Spectral Acceleration at 1.0 sec. (S_{D1}) = 0.037g
Design Spectral Acceleration at 0.2 sec. (S_{D5}) = 0.080g
Soil Site Class = B

GENERAL PLAN & ELEVATION

I-74 OVER I-280
F.A.I. RTE. 74 - SEC. 81-2HBR-2
ROCK ISLAND COUNTY
STATION 194+17.09
STRUCTURE NO. 081-0159 (S.B.)
STRUCTURE NO. 081-0160 (N.B.)

FILE NAME =	USER NAME =	DESIGNED -	REVISD -	STATE OF ILLINOIS DEPARTMENT OF TRANSPORTATION	F.A.I. RTE. 74	SECTION 81-2HBR-2	COUNTY ROCK ISLAND	TOTAL SHEETS	SHEET NO.
	PLOT SCALE =	CHECKED -	REVISD -		SHEET NO. 1 OF 2 SHEETS			CONTRACT NO. 12345	
	PLOT DATE =	DRAWN -	REVISD -						
		CHECKED -	REVISD -						

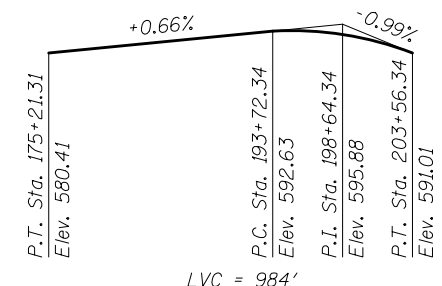

PROFILE GRADE F.A.I. RTE. 74

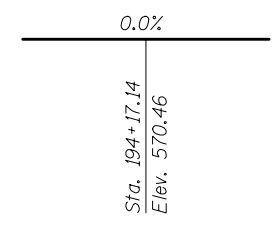

PROFILE GRADE F.A.I. RTE. 280

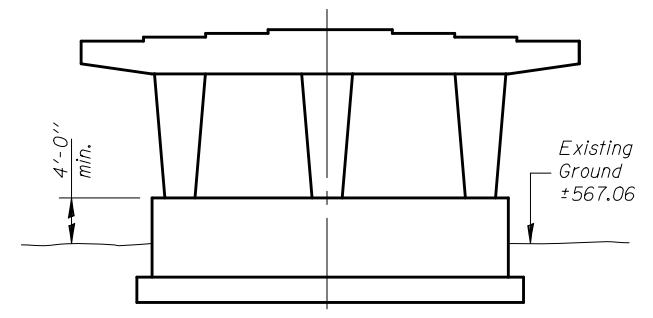

PIER SKETCH

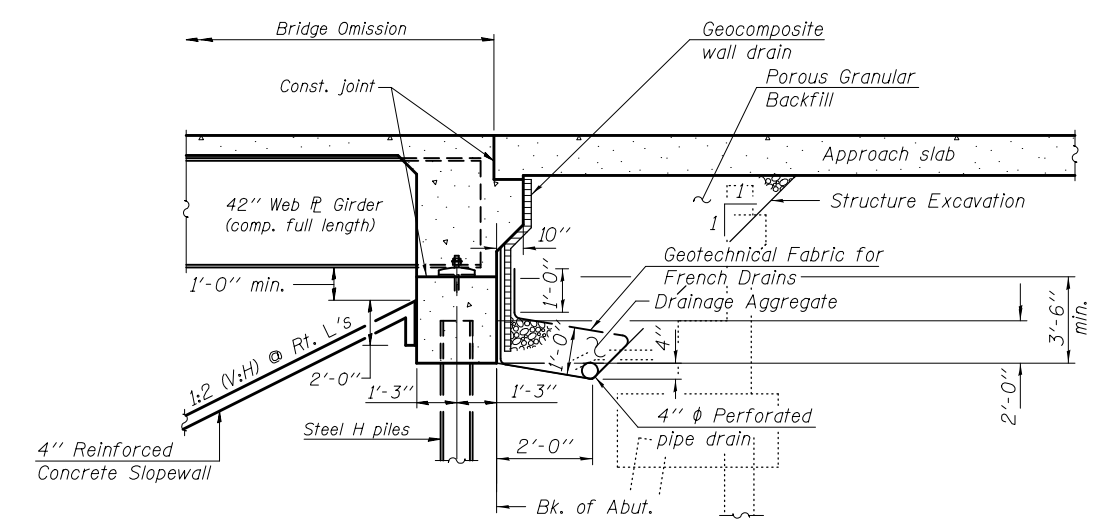

SECTION THRU ABUTMENT
(Horizontal Dimensions @ Rt. L's)

DETAILS
I-74 OVER I-280
F.A.I. RTE. 74 - SEC. 81-2HBR-2
ROCK ISLAND COUNTY
STATION 194+17.09
STRUCTURE NO. 081-0159 (S.B.)
STRUCTURE NO. 081-0160 (N.B.)

FILE NAME =	USER NAME =	DESIGNED -	REVISD -	STATE OF ILLINOIS DEPARTMENT OF TRANSPORTATION	SHEET NO. 2 OF 2 SHEETS	F.A.I. RTE.	SECTION	COUNTY	TOTAL SHEETS	SHEET NO.	
		CHECKED -	REVISD -			74	81-2HBR-2	ROCK ISLAND			
		DRAWN -	REVISD -			CONTRACT NO. 12345					
		CHECKED -	REVISD -			ILLINOIS FED. AID PROJECT					