

Bench Mark: M-234 B.M. Elev. 464.95 brass disk in the S.W. corner of existing S.N. 090-0048.

Existing Structure: S.N. 090-0048 Built in 1958 as S.B.I. Rte. 24, Section 11BR-1 at Station 275+77.36 as a 3-span continuous RC slab bridge 61'-0" Bk.- to Bk. of abutments with two 24 ft. roadways and a 4 ft. median. Open pile abutments and piers, supported on concrete piles. Existing structure to be removed & replaced. Traffic to be maintained using stage construction.

No salvage

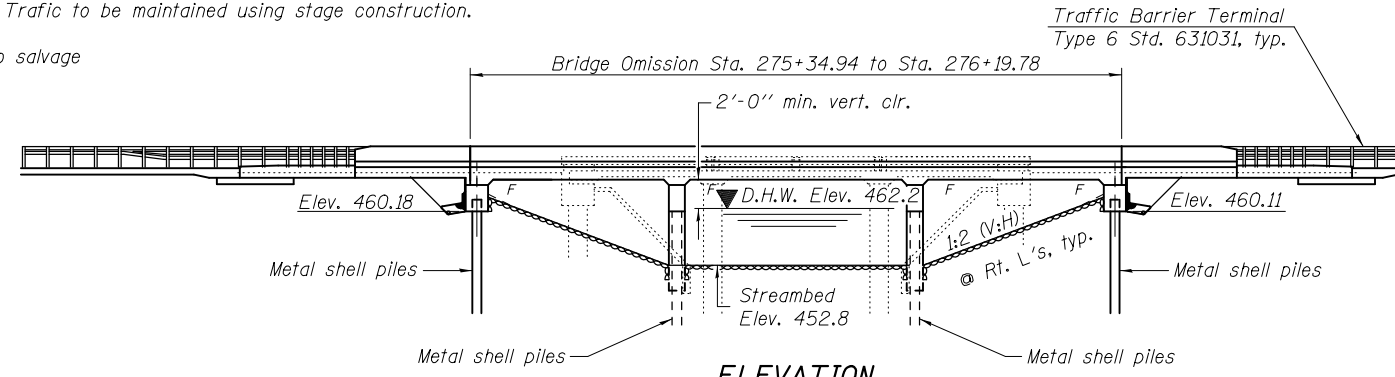

ELEVATION

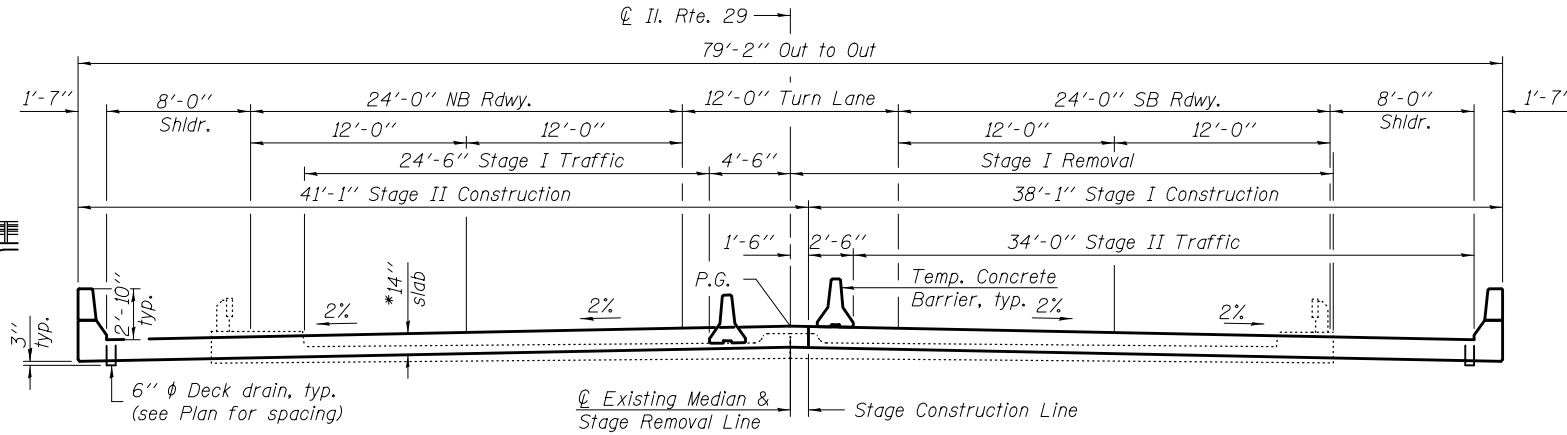

CROSS SECTION

(Looking South)
*Subject to refinement during design.

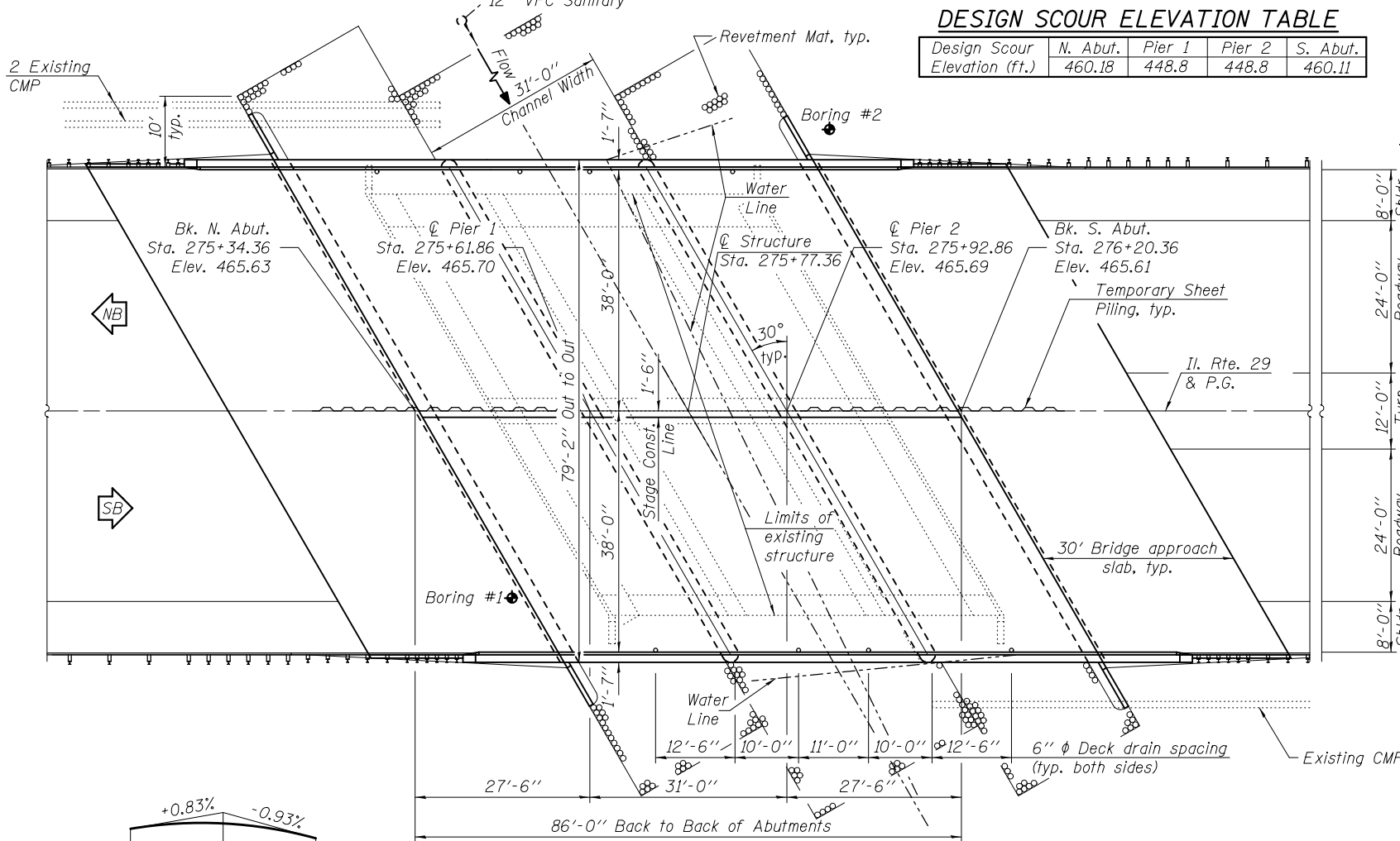

PLAN

WATERWAY INFORMATION

Drainage Area = 2.5 mi. ²		Low Grade Elev. 461.4 (E&P) @ Sta. 281+00				
Flood	Freq. Yr.	Q C.F.S.	Opening Sq. Ft. Exist. Prop.	Nat. H.W.E. Exist. Prop.	Head - Ft. Exist. Prop.	Headwater El. Exist. Prop.
	10	1032	119 208	458.4 458.4	1.8 0.0	460.2 458.4
Overtop (E)	30	1400	159 208	460.1 461.4	1.3 0.0	461.4 461.4
Overtop (P)	40	1600	372 421	461.4 462.2	0.0 0.5	461.4 462.7
Design	50	1795	251 533	462.2 464.7	0.5 0.2	462.7 464.9
Base	100	2119	298 533	464.7 465.2	0.2 0.1	464.9 465.5
Max. Calc.	500	2924	298 533	465.2 465.2	0.3 0.1	465.5 465.3

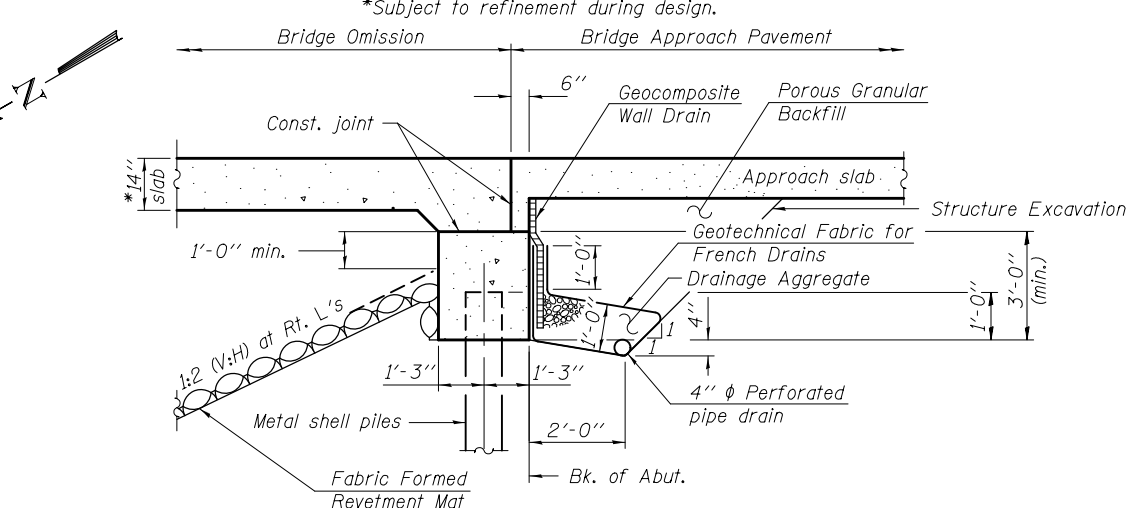
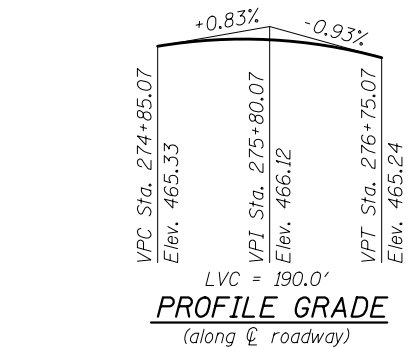

SECTION THRU ABUTMENT

(Horiz. Dimensions @ Rt. L's)

HIGHWAY CLASSIFICATION
F.A.P. Rte. 669 - Il. Rte. 29
Functional Class: Other Principal Arterial
ADT: 24,300 (1999); 31,411 (2020)
ADTT: 1,700 (1999); 2,200 (2020)
DHV: 2530
Speed: 45 m.p.h. (posted); 55 m.p.h. (design)
Two-way traffic Directional Dist: 50:50

LOADING HL 93
Allow 50#/sq. ft. for future wearing surface.

DESIGN SPECIFICATIONS
2010 AASHTO LRFD Bridge Design Specifications

DESIGN STRESSES
FIELD UNITS
 $f'_c = 3,500$ psi
 $f_y = 60,000$ psi (reinforcement)

SEISMIC DATA
Seismic Performance Zone (SPZ) = 1
Design Spectral Acceleration at 1.0 sec. (S_{D1}) = 0.050g
Design Spectral Acceleration at 0.2 sec. (S_{D5}) = 0.13g
Soil Site Class = B

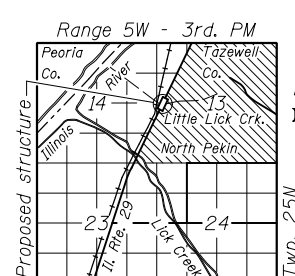

LOCATION SKETCH

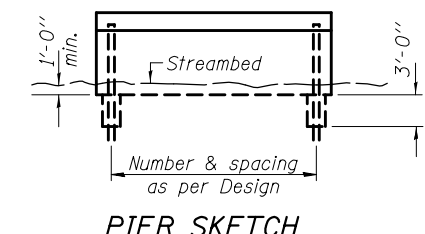

PIER SKETCH

GENERAL PLAN & ELEVATION
ILLINOIS ROUTE 29 OVER
LITTLE LICK CREEK
F.A.P. RTE. 669 - SEC. 11BR-2
TAZEWELL COUNTY
STATION 275+77.36
STRUCTURE NO. 090-0174