

Bench Mark: P.K. nail in power pole 42' LT. Sta. 498+87 (U.S.-136) Elev. 731.39
 Existing Structure: None

HIGHWAY CLASSIFICATION

F.A.P. Rte. 315 - U.S. Rte. 136
 Functional Class: Other Principal Arterial
 ADT: 5,100 (2005); 6,400 (2025)
 ADTT: 765 (2005); 960 (2025)
 DHV: 770 (2025)
 Design Speed: 45 m.p.h.
 Posted Speed: 45 m.p.h.

F.A.P. Rte. 322 - U.S. Rte. 51
 Functional Class: Other Principal Arterial
 ADT: 4,650 (2005); 6,900 (2025)
 ADTT: 700 (2005); 1,035 (2025)
 DHV: 830 (2025)
 Design Speed: 70 m.p.h.
 Posted Speed: 65 m.p.h.

LOADING HL-93

Allow 50#/sq. ft. for future wearing surface.

DESIGN SPECIFICATIONS

2010 AASHTO LRFD Bridge Design Specifications

DESIGN STRESSES

FIELD UNITS

$f'_c = 3,500$ psi
 $f_y = 50,000$ psi (AASHTO M-270, Grade 50)
 $f_y = 60,000$ psi (reinforcement)

SEISMIC DATA

Seismic Performance Zone (SPZ) = 1
 Design Spectral Acceleration at 1.0 sec. (S_{D1}) = 0.13 g
 Design Spectral Acceleration at 0.2 sec. (S_{D5}) = 0.21 g
 Soil Site Class = D

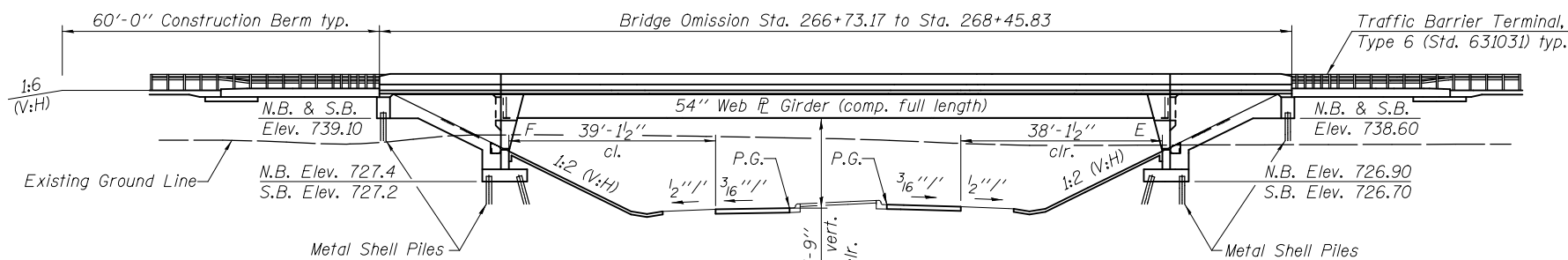

ELEVATION

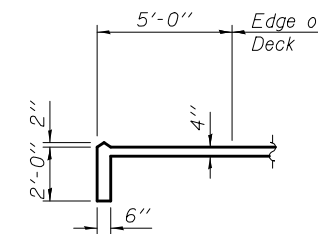

SECTION B-B

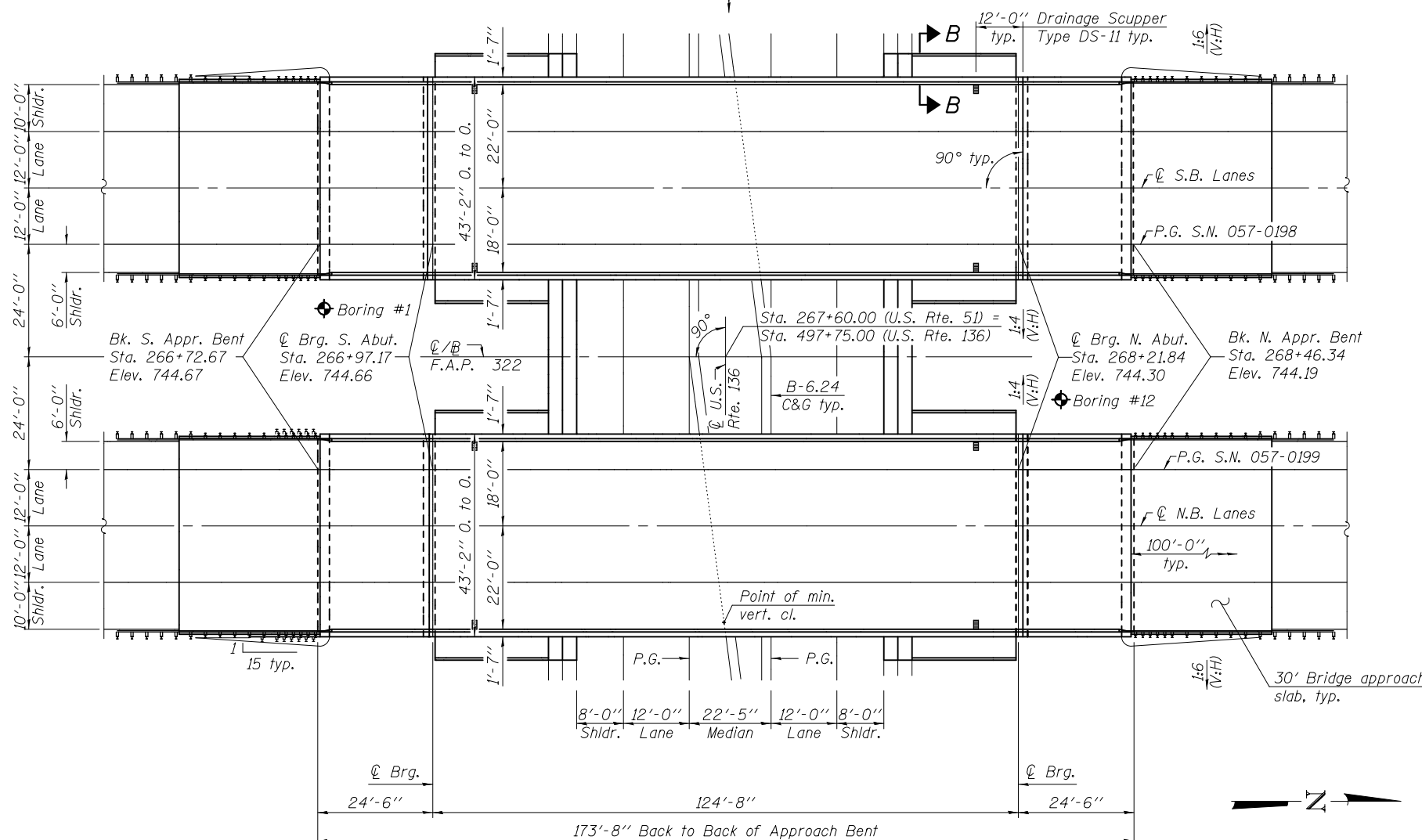

PLAN

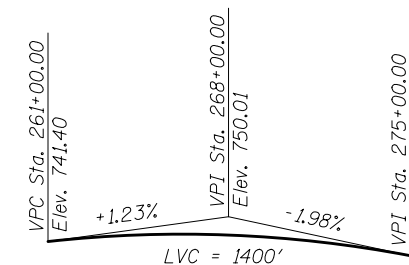

PROFILE GRADE U.S. RTE. 51

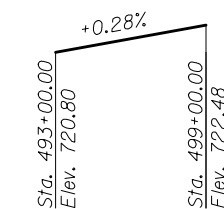

PROFILE GRADE U.S. RTE. 136

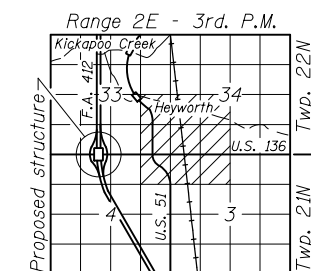

LOCATION SKETCH

GENERAL PLAN & ELEVATION
U.S. ROUTE 51 OVER U.S. ROUTE 136
F.A.P. RTE. 322 - SEC. 57-1HB
McLEAN COUNTY
STATION 267+60.00
STRUCTURE NO. 057-0198 (S.B.)
STRUCTURE NO. 057-0199 (N.B.)

FILE NAME =	USER NAME =	DESIGNED -	REVISD -	STATE OF ILLINOIS DEPARTMENT OF TRANSPORTATION	F.A.P. RTE. 322	SECTION 57-1HB	COUNTY McLEAN	TOTAL SHEETS	SHEET NO.
		CHECKED -	REVISD -						
		DRAWN -	REVISD -						
		CHECKED -	REVISD -						
SHEET NO. 1 OF 2 SHEETS					CONTRACT NO. 12345				
ILLINOIS FED. AID PROJECT									

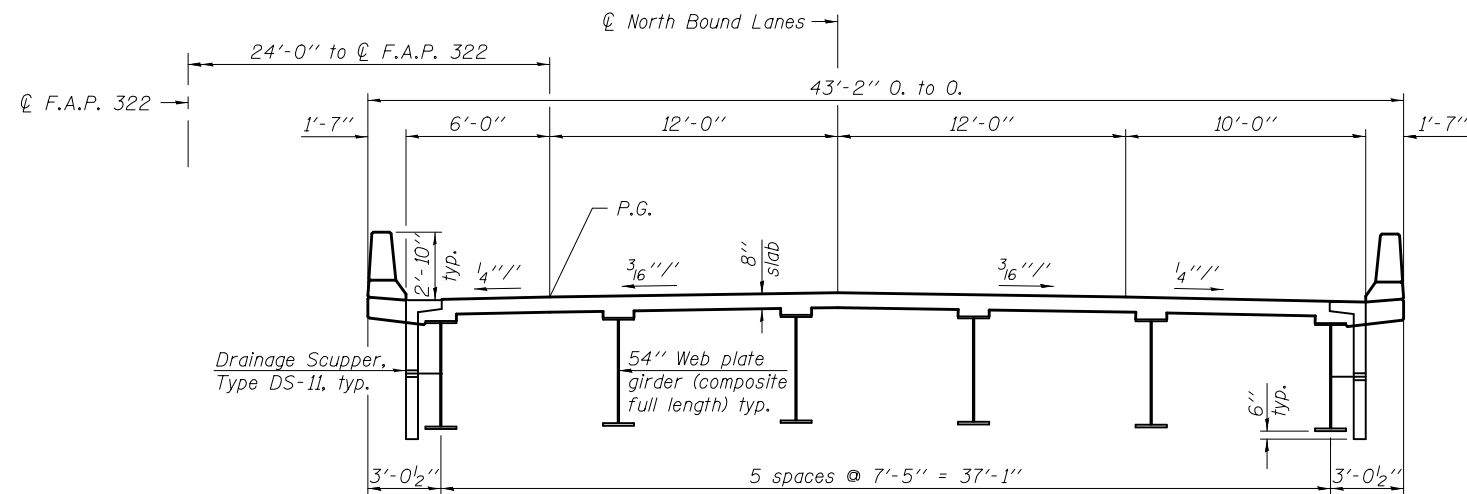

CROSS SECTION THRU BRIDGE DECK

(S.N. 057-0199 Looking North shown, S.N. 057-0198 similar)

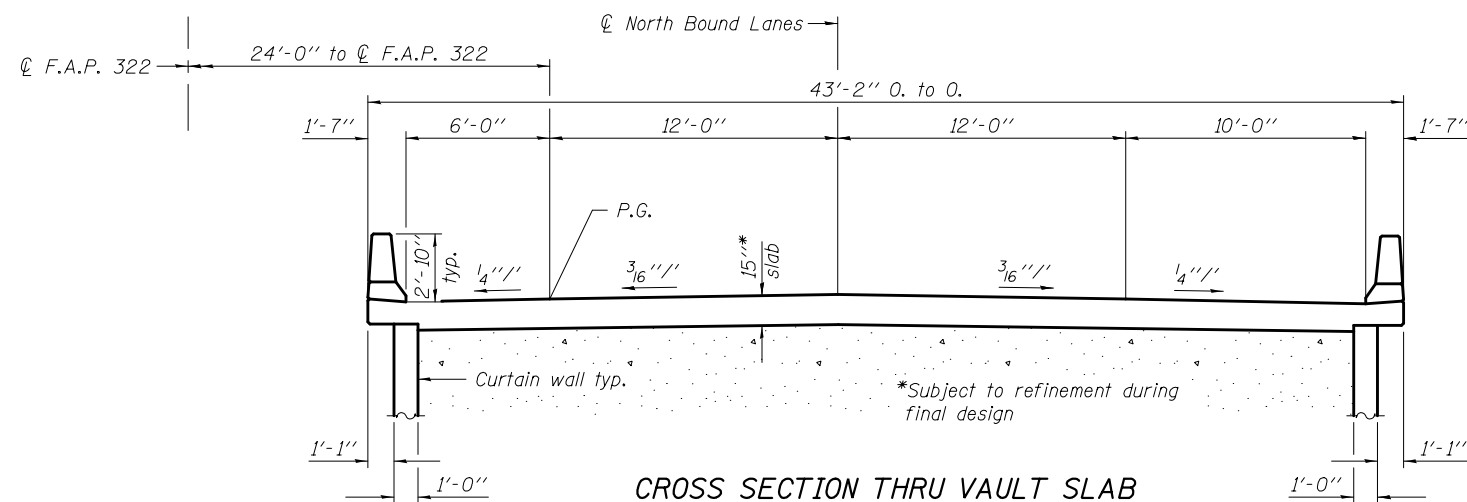

CROSS SECTION THRU VAULT SLAB

(S.N. 057-0199 Looking North shown, S.N. 057-0198 similar)

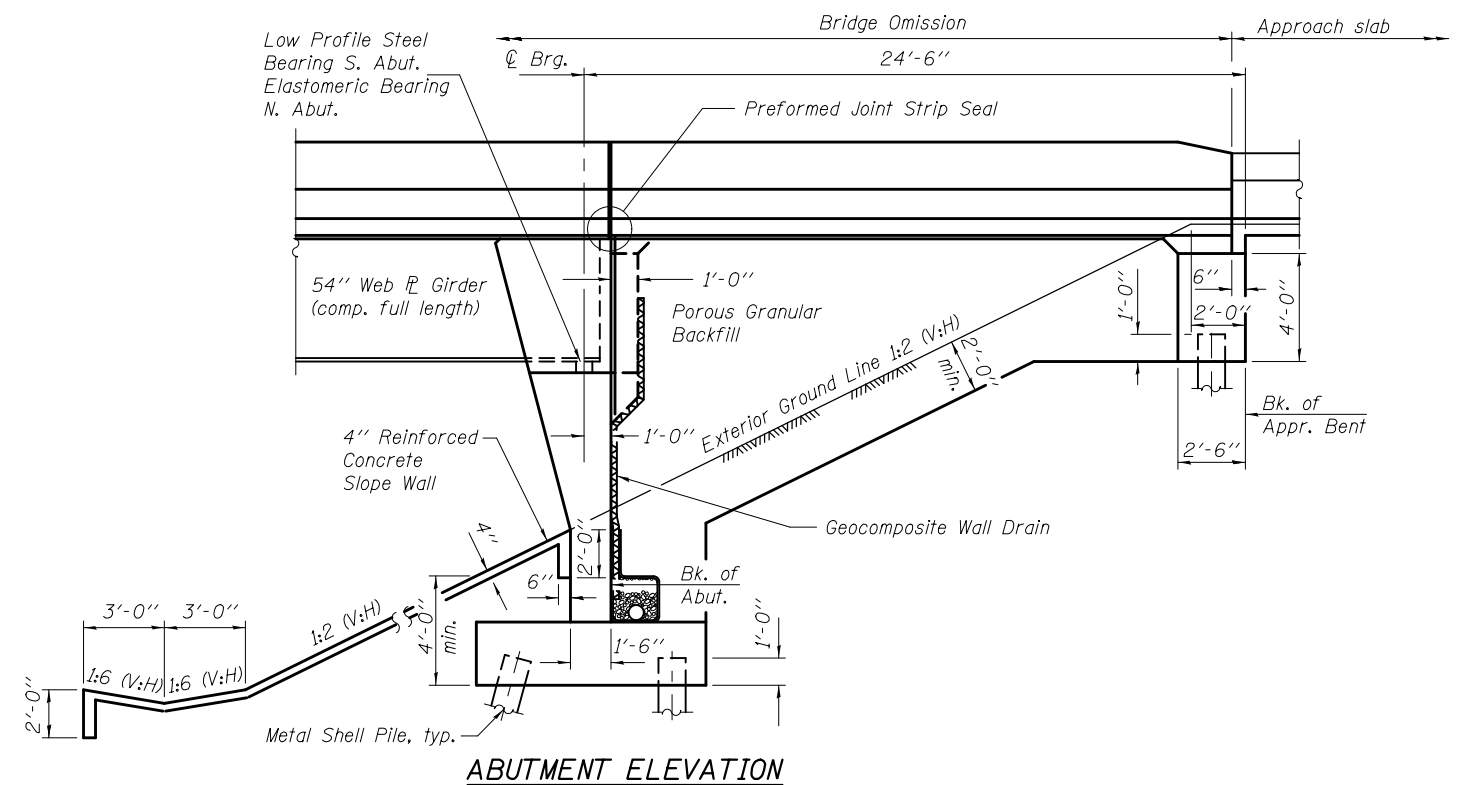

ABUTMENT ELEVATION

DETAILS
U.S. ROUTE 51 OVER U.S. ROUTE 136
F.A.P. RTE. 322 - SEC. 57-1HB
McLEAN COUNTY
STATION 267+60.00
STRUCTURE NO. 057-0198 (S.B.)
STRUCTURE NO. 057-0199 (N.B.)

FILE NAME =	USER NAME =	DESIGNED -	REVISED -	STATE OF ILLINOIS DEPARTMENT OF TRANSPORTATION	SHEET NO. 2 OF 2 SHEETS	F.A.P. RTE. 322	SECTION 57-1HB	COUNTY McLEAN	TOTAL SHEETS	SHEET NO.	
		CHECKED -	REVISED -								
		DRAWN -	REVISED -								
		CHECKED -	REVISED -								
						CONTRACT NO. 12345		ILLINOIS FED. AID PROJECT			