

**PLAN**

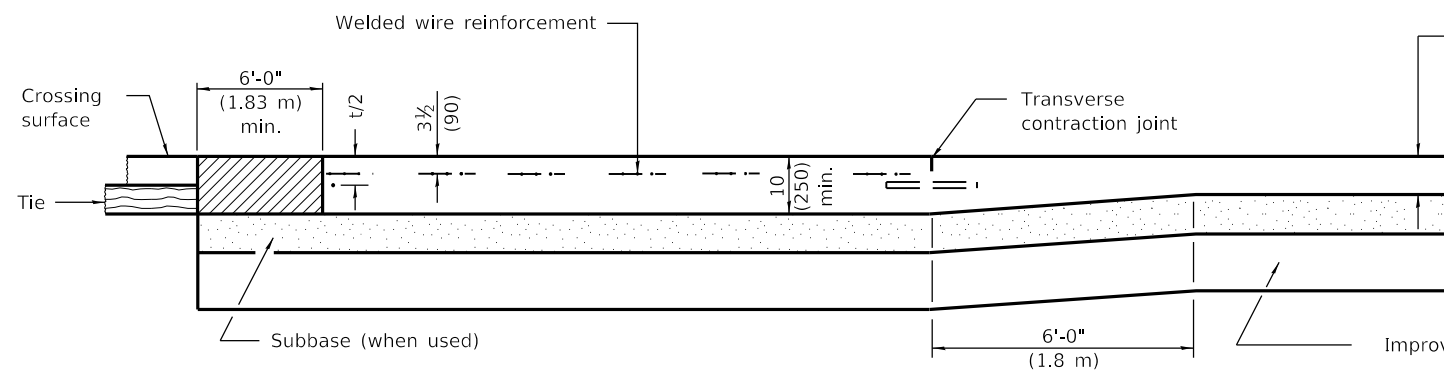

**SECTION A-A**  
(FOR PCC PAVEMENT)

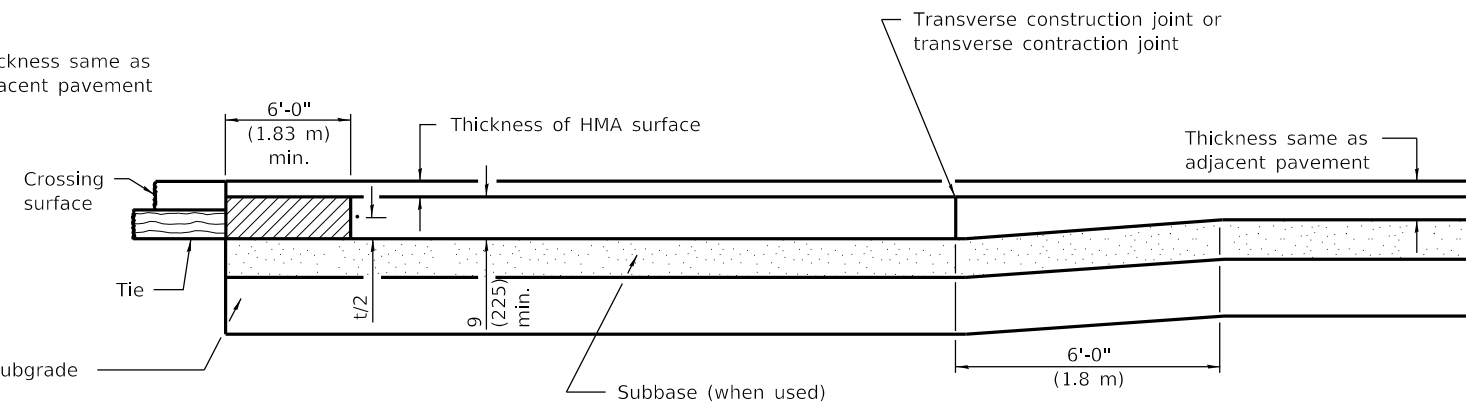

**SECTION A-A**  
(FOR PCC BASE COURSE WITH HMA SURFACE)

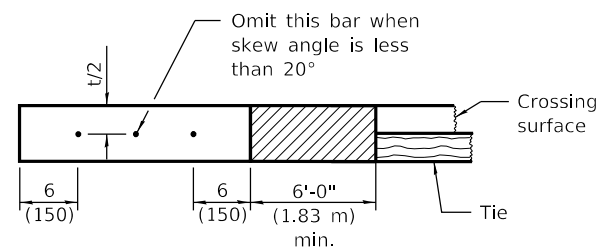

**SECTION B-B**

**GENERAL NOTES**

See Standard 420001 for joint details not shown.

All dimensions are in inches (millimeters) unless otherwise shown.

DATE	REVISIONS
1-1-18	Revised standard to reflect change of tie bar spacing to 36 (900) cts.
4-1-16	Changed terminology to 'welded wire reinforcement'.

**PCC PAVEMENT AND PCC BASE COURSE ADJACENT TO RAILROAD GRADE CROSSING**

**STANDARD 420501-07**

Illinois Department of Transportation

PASSED January 1, 2018  
*Michael Beard*  
 ENGINEER OF POLICY AND PROCEDURES

APPROVED January 1, 2018  
*Maureen M. Beck*  
 ENGINEER OF DESIGN AND ENVIRONMENT

ISSUED 1-1-97