

TYPE B GUTTER

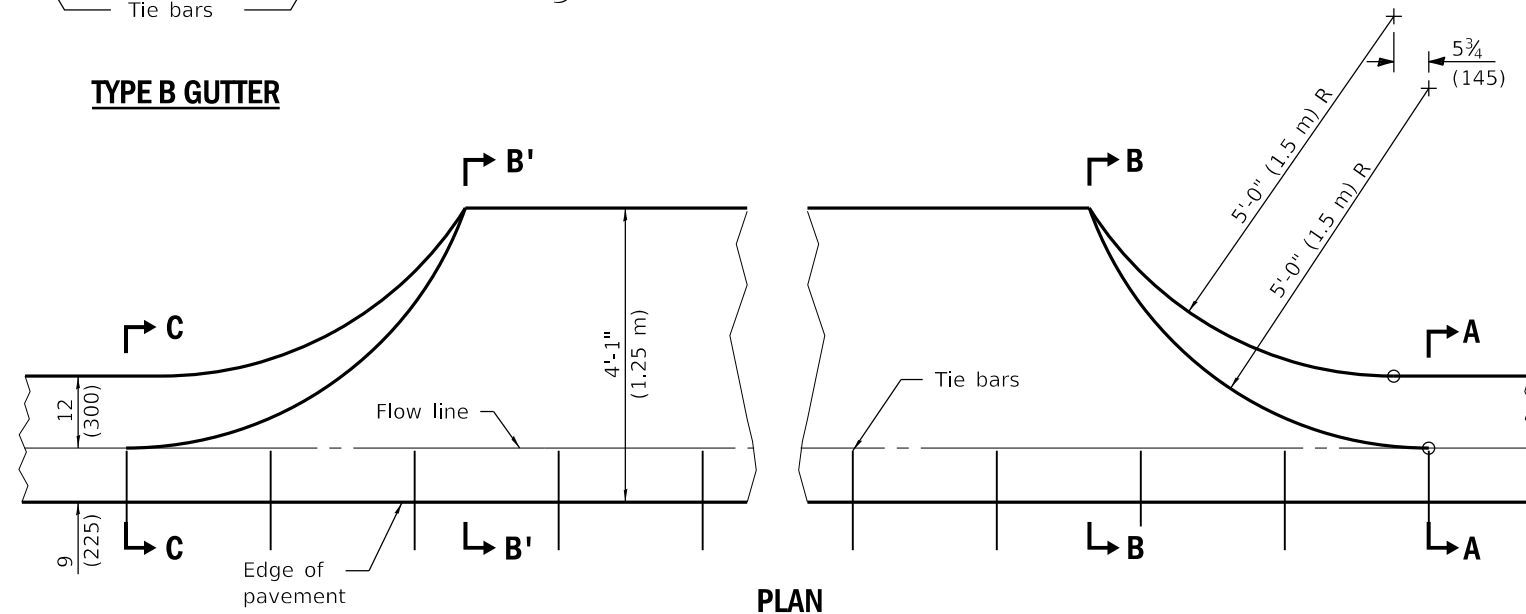

PLAN

QUANTITY OF CONCRETE
 Section B'-B' to B-B = 0.076 cu. yd./ft. (0.19 m³/m)
 Section (C-C to B'-B') + (B-B to A-A) = 0.44 cu. yd. (0.34 m³)

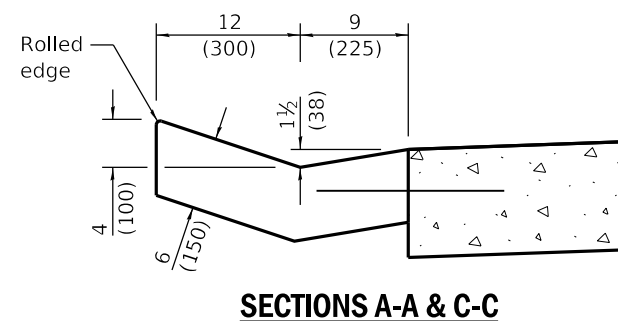

SECTIONS A-A & C-C

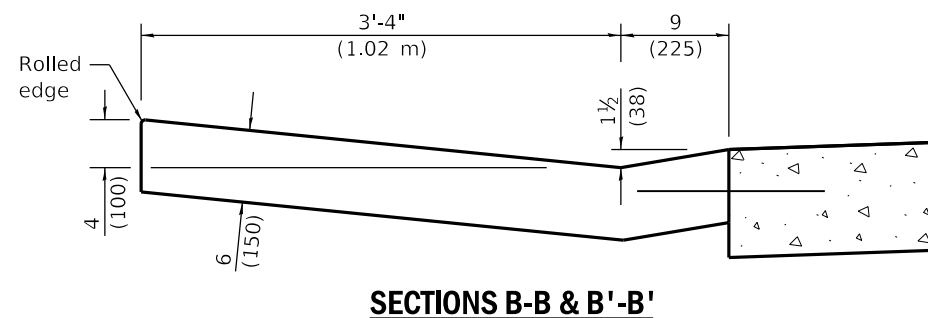

SECTIONS B-B & B'-B'

ENTRANCE

GENERAL NOTES

Gutter, gutter inlet, gutter outlet and gutter entrance shall be tied to the pavement in accordance with details for longitudinal construction joint shown on Standard 420001.

Two 1-1/4 x 18 (32 x 450) dowel bars shall be installed in all joints when the gutter is constructed adjacent to flexible pavement.

All dimensions are in inches (millimeters) unless otherwise shown.

**TYPE B GUTTER
 (INLET, OUTLET & ENTRANCE)**

(Sheet 1 of 2)

STANDARD 606201-04

DATE	REVISIONS
1-1-18	Deleted first General Note to avoid conflict with second General Note.
4-1-16	Changed terminology to 'welded wire reinforcement'.

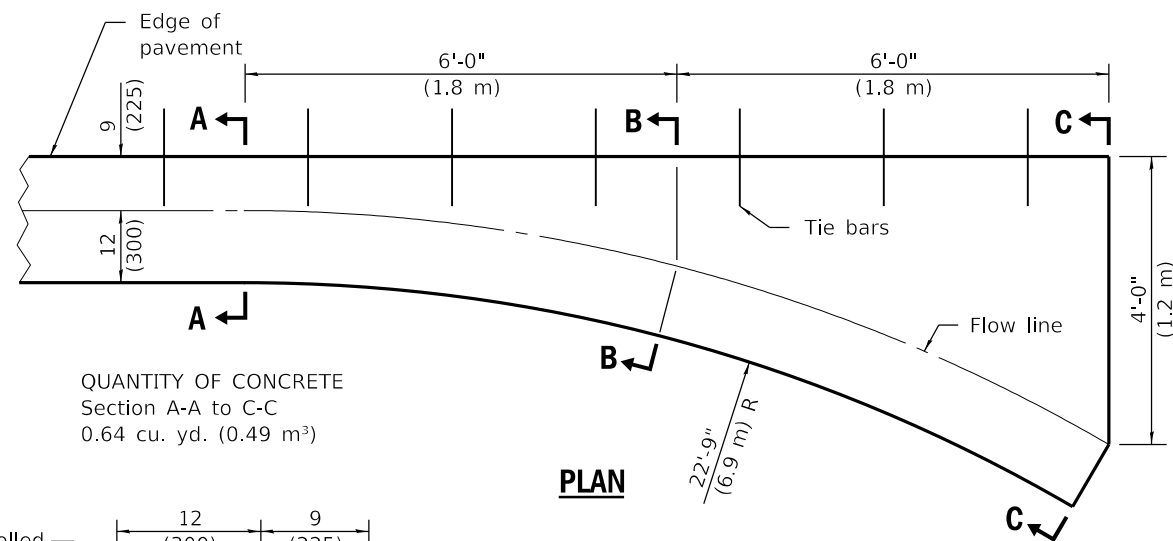

PLAN

QUANTITY OF CONCRETE
 Section A-A to C-C
 0.64 cu. yd. (0.49 m³)

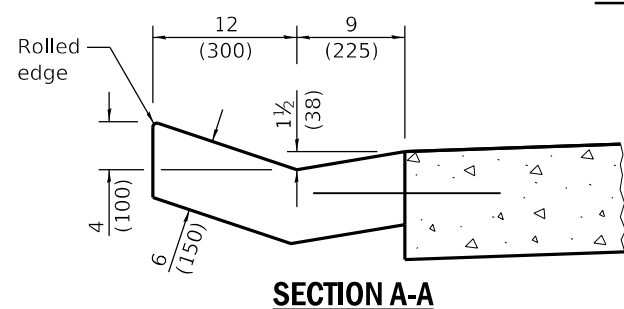

SECTION A-A

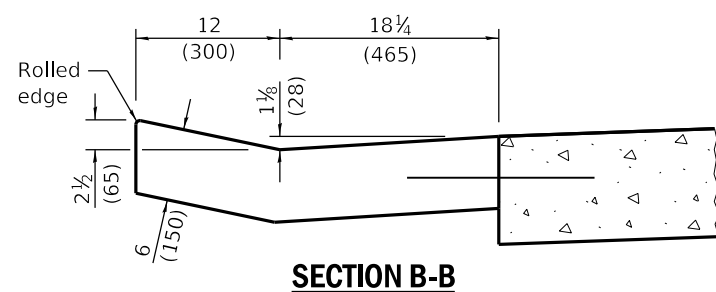

SECTION B-B

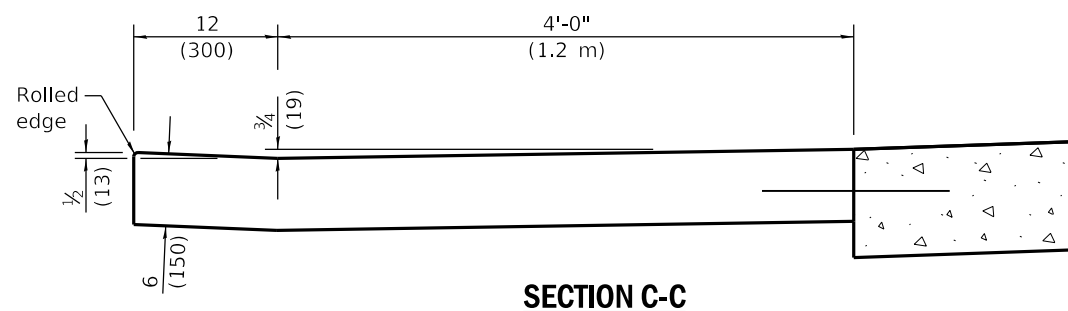

SECTION C-C

INLET

Illinois Department of Transportation

PASSED January 1, 2018
Michael Beard
 ENGINEER OF POLICY AND PROCEDURES

APPROVED January 1, 2018
Marcus M. Beck
 ENGINEER OF DESIGN AND ENVIRONMENT

ISSUED 1-1-97

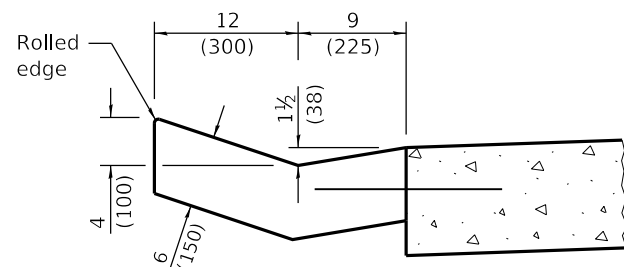

SECTION A-A

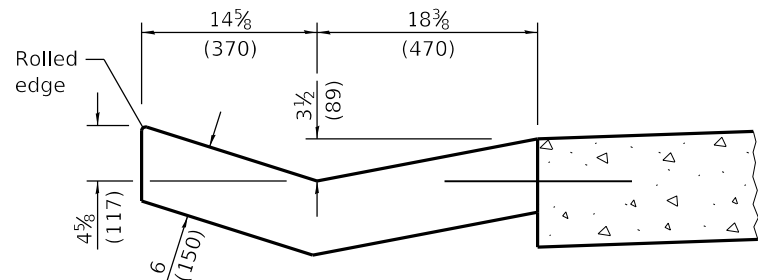

SECTION B-B

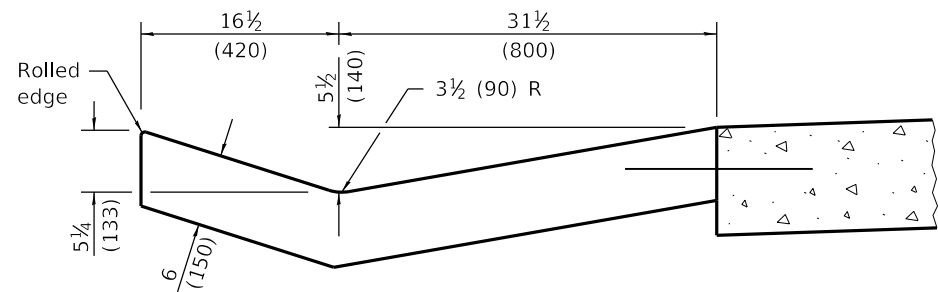

SECTION C-C

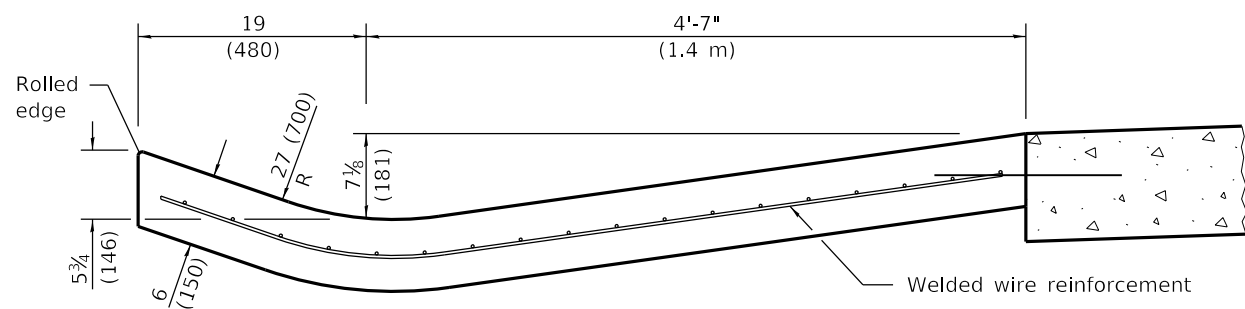

SECTION D-D

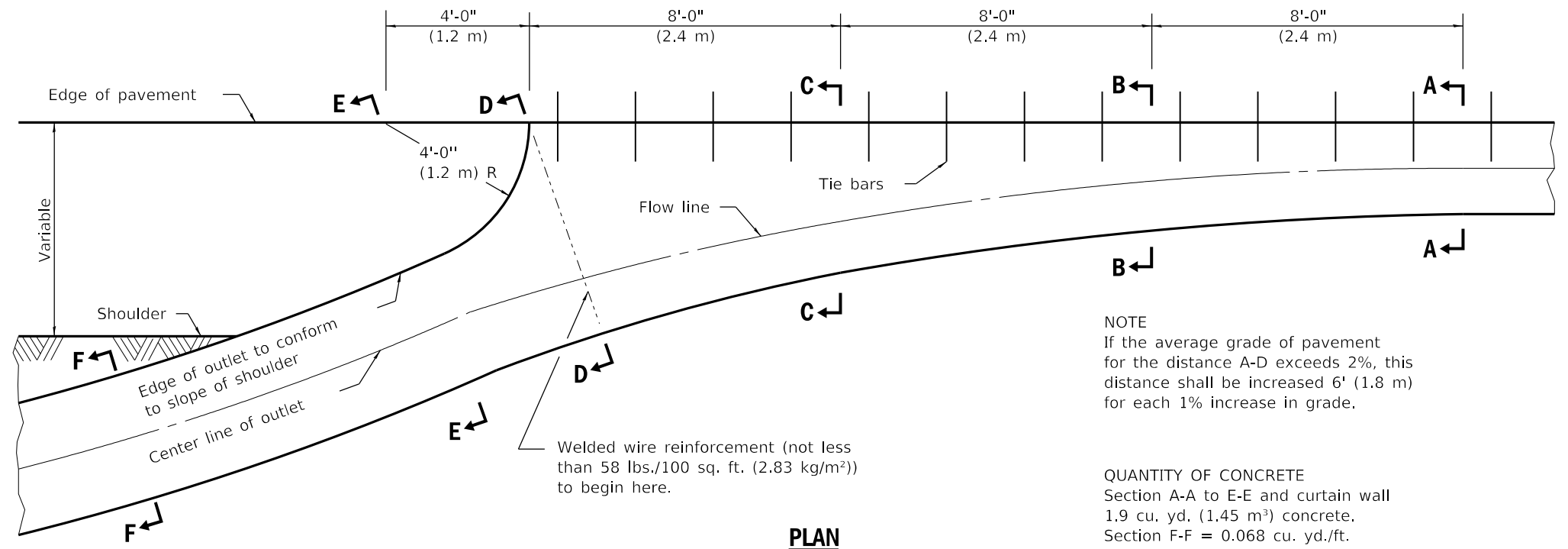

PLAN

NOTE
If the average grade of pavement for the distance A-D exceeds 2%, this distance shall be increased 6' (1.8 m) for each 1% increase in grade.

QUANTITY OF CONCRETE
Section A-A to E-E and curtain wall 1.9 cu. yd. (1.45 m³) concrete.
Section F-F = 0.068 cu. yd./ft. (0.17 m³/m).

OUTLET

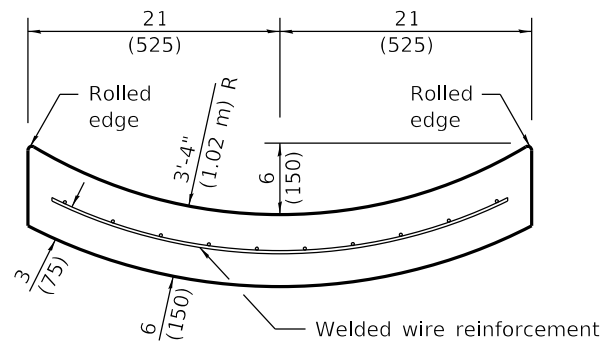

SECTION F-F

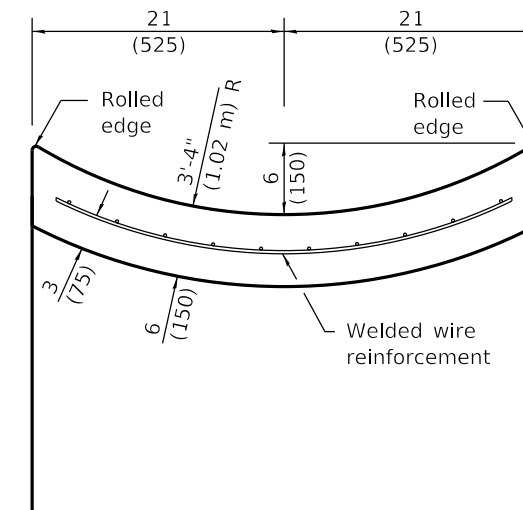

SECTIONS AT END OF OUTLET

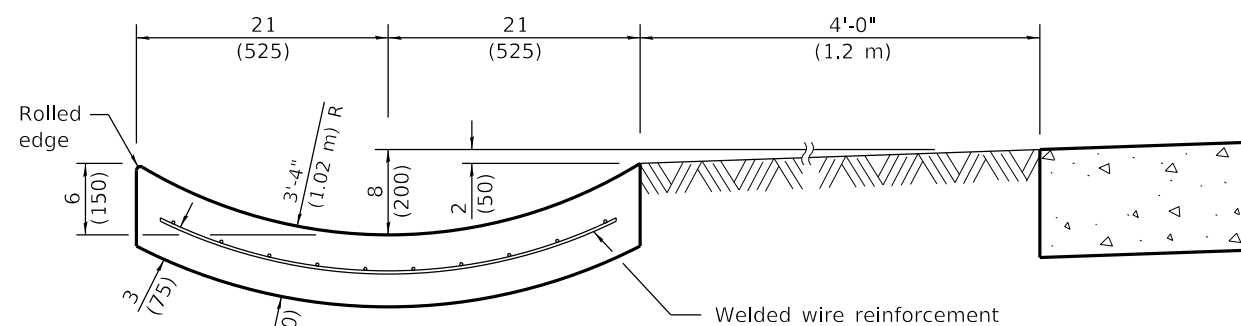
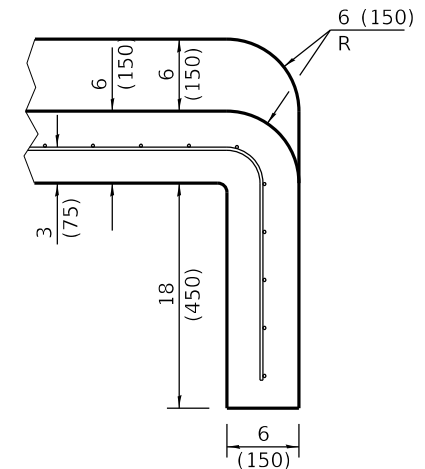

SECTION E-E

Illinois Department of Transportation
PASSED January 1, 2018
Michael Beard
ENGINEER OF POLICY AND PROCEDURES
APPROVED January 1, 2018
Maureen M. Adams
ENGINEER OF DESIGN AND ENVIRONMENT
ISSUED 1-1-97

**TYPE B GUTTER
(INLET, OUTLET & ENTRANCE)**

(Sheet 2 of 2)

STANDARD 606201-04