

ELEVATION

① When connecting to long-span guardrail over culvert, the next post may be the third (farthest from culvert) CRT wood post (See Standard 630106).

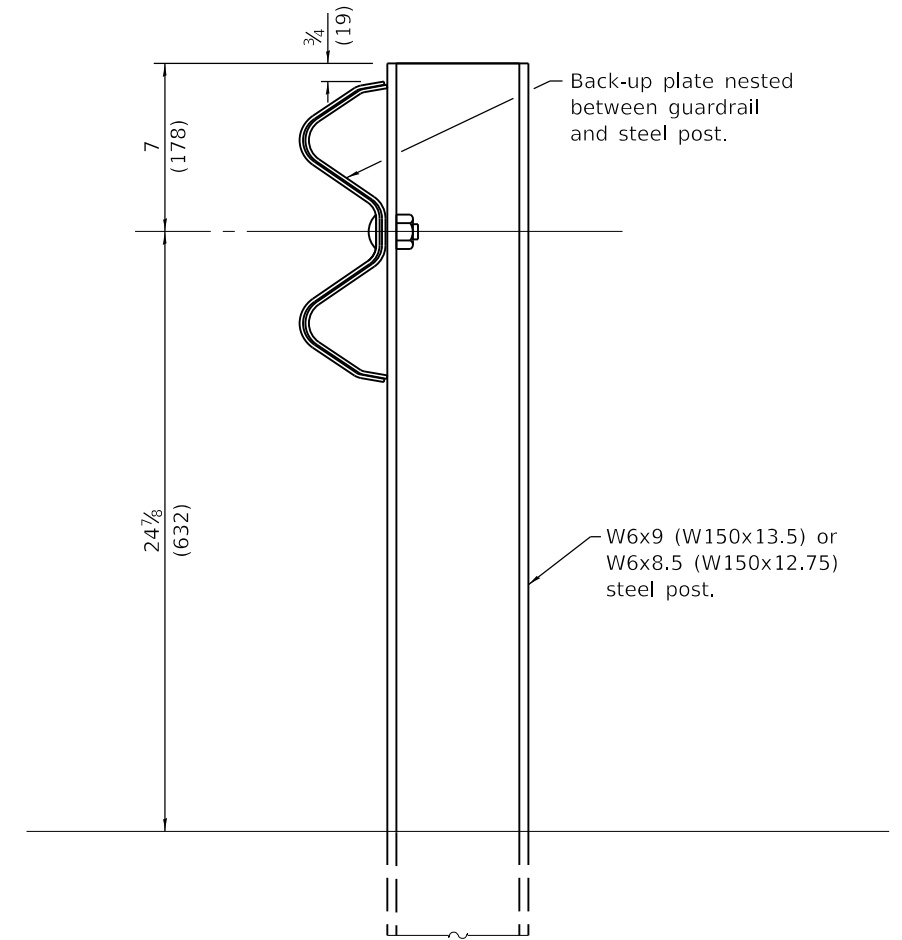

DETAIL AT POST

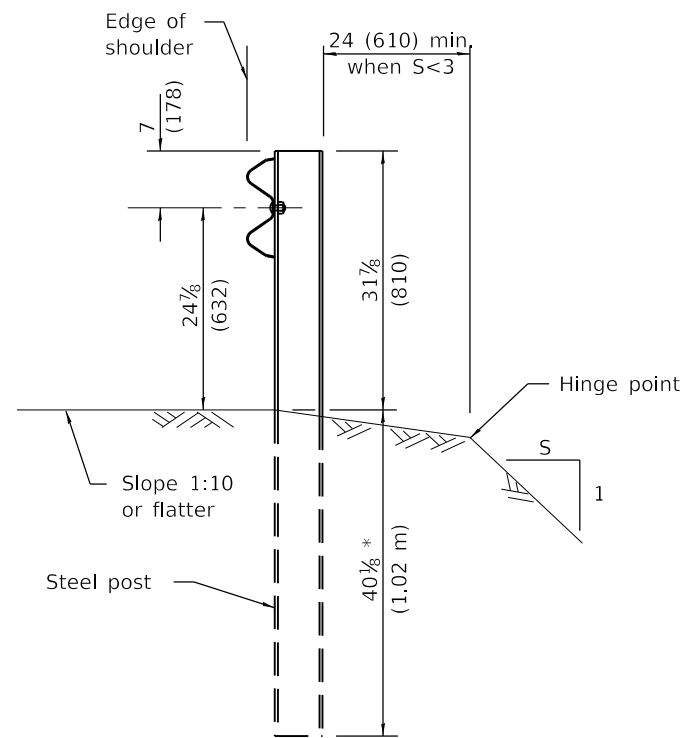

SECTION A-A

* When "S" is less than 3 and the distance from the back of post is less than 24 (610), the post embedment shall be 76 1/8 (1.93 m) and the minimum top of rail height shall be 31 (787).

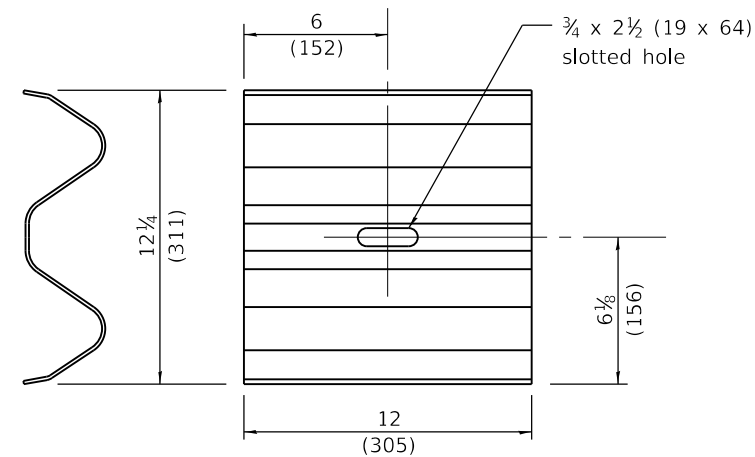

BACK-UP PLATE

GENERAL NOTES

All slope ratios are expressed as units of vertical displacement to units of horizontal displacement (V:H).

For details of guardrail elements not shown, see Standard 630001.

All dimensions are in inches (millimeters) unless otherwise shown.

DATE	REVISIONS
1-1-17	New standard.

NON-BLOCKED STEEL PLATE BEAM GUARDRAIL

(Sheet 1 of 2)

STANDARD 630006

Illinois Department of Transportation

PASSED January 1, 2017
Michael Beard
 ENGINEER OF POLICY AND PROCEDURES

APPROVED January 1, 2017
Maureen M. Beck
 ENGINEER OF DESIGN AND ENVIRONMENT

ISSUED 1-1-17

V	W	L
0 - 6 (0 - 152)	24 (610)	21 (530)
> 6 - 18 (> 152 - 458)	18 (458)	14½ (368)
> 18 - 31 (> 458 - 787)	12 (305)	8 (203)
> 31 - 40½ (> 787 - 1.02 m)	12 - 0 (305 - 0)	8 (203)

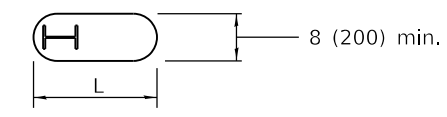

PLAN

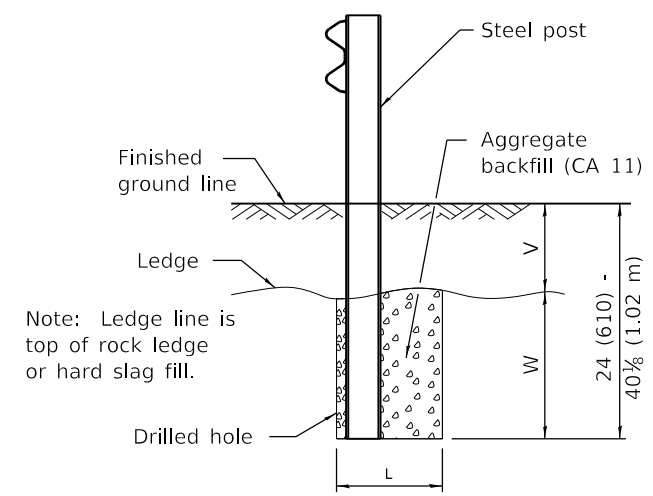

ELEVATION

FOOTING FOR POST WHEN IMPERVIOUS MATERIAL IS ENCOUNTERED

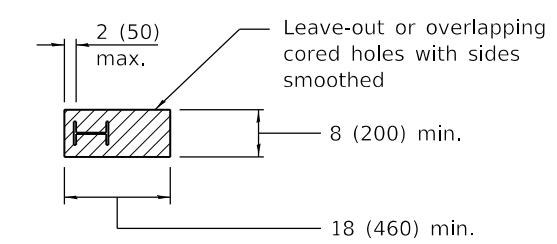

PLAN

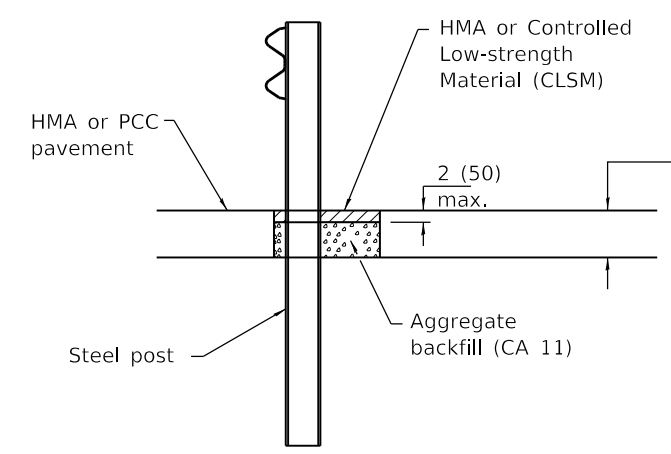

ELEVATION

LEAVE-OUT FOR POST WHEN PAVED MATERIAL IS ENCOUNTERED

Illinois Department of Transportation

PASSED January 1, 2017
Michael Beard
 ENGINEER OF POLICY AND PROCEDURES

APPROVED January 1, 2017
Marcus M. Adams
 ENGINEER OF DESIGN AND ENVIRONMENT

ISSUED 1-1-17

NON-BLOCKED STEEL PLATE BEAM GUARDRAIL

(Sheet 2 of 2)

STANDARD 630006